

Applying Markdown to Questions

Step 1: Access Your Account

[Sign into](#) your account and follow these steps to create a survey distribution in PsychData.

Step 2: Navigate to the Designer Page

When you are done building your survey and are ready to distribute it to your participants, you will need to make sure that you have selected the correct survey. Navigate to the Surveys page by clicking the word “Surveys” at the top of the screen.

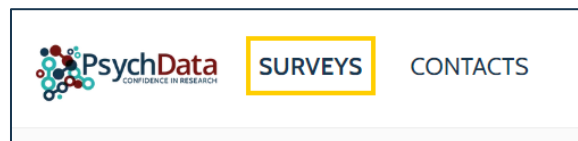

Locate the survey you want to apply markdown to within the list by clicking anywhere within the area indicated below to enter the “Designer” page of the survey.

Note if you click directly on the name, it will open the name as a field to be updated.

Example	10215	0	●					
EXAMPLE SURVEY	10137	0	●					
TEST	10203	1	●					

This will take you into the selected Design page, which can also be accessed from any other page within the survey by either clicking the “Design” tab in the menu on the left-hand side of the screen or by selecting “Designer” in the banner across the top of your survey.

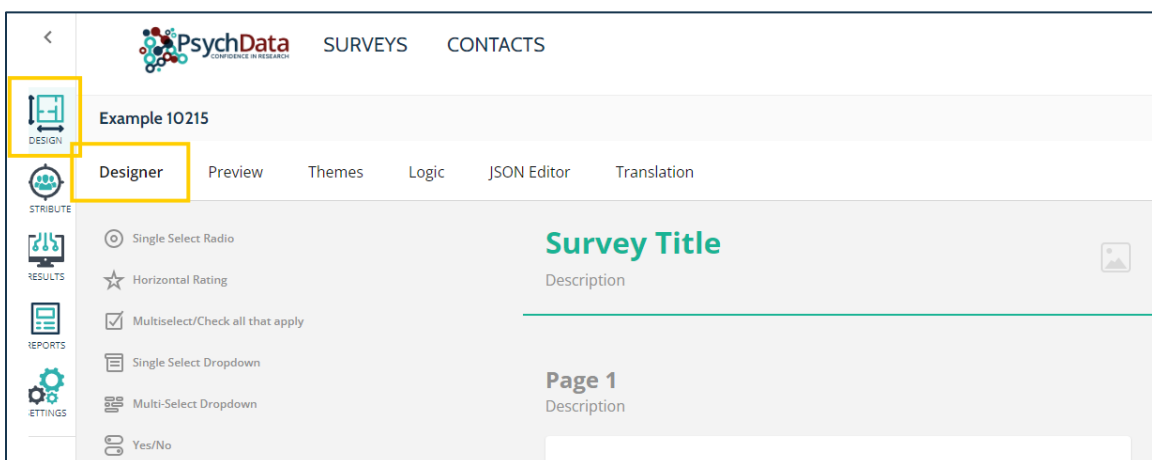

Step 3: Add HTML box

You can click on “</> HTML” the list of question types on the right-hand side of the screen

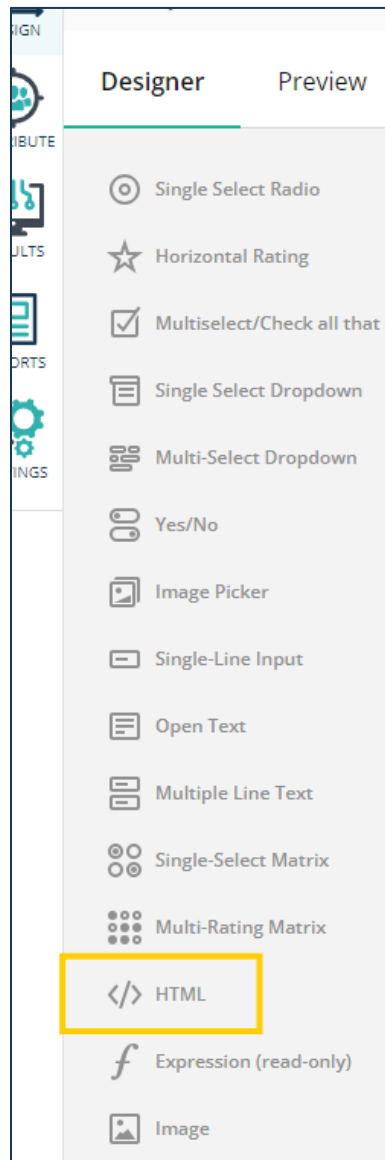

OR on the “Add Question” button within the survey, where you want to add the markdown.

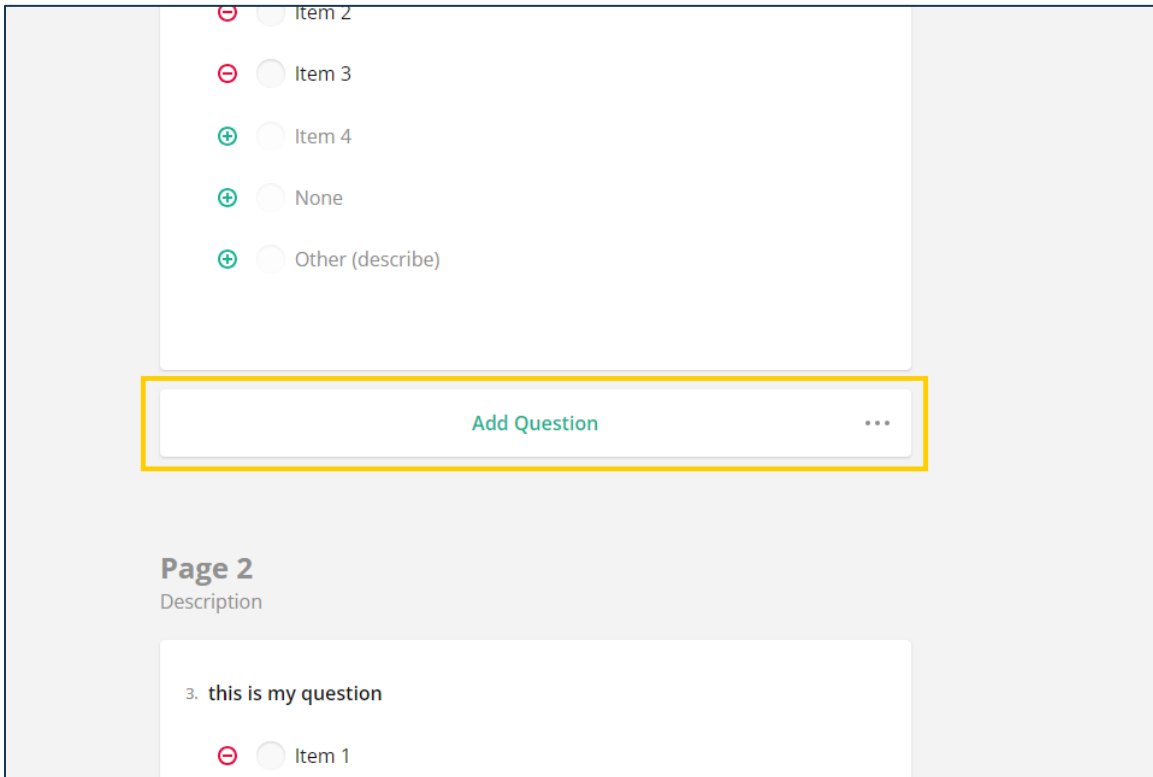

⊖ Item 2

⊖ Item 3

⊕ Item 4

⊕ None

⊕ Other (describe)

Add Question ...

Page 2
Description

3. this is my question

⊖ Item 1

And select “</> HTML” from the dropdown list in the bottom left-hand corner of the question space that appears.

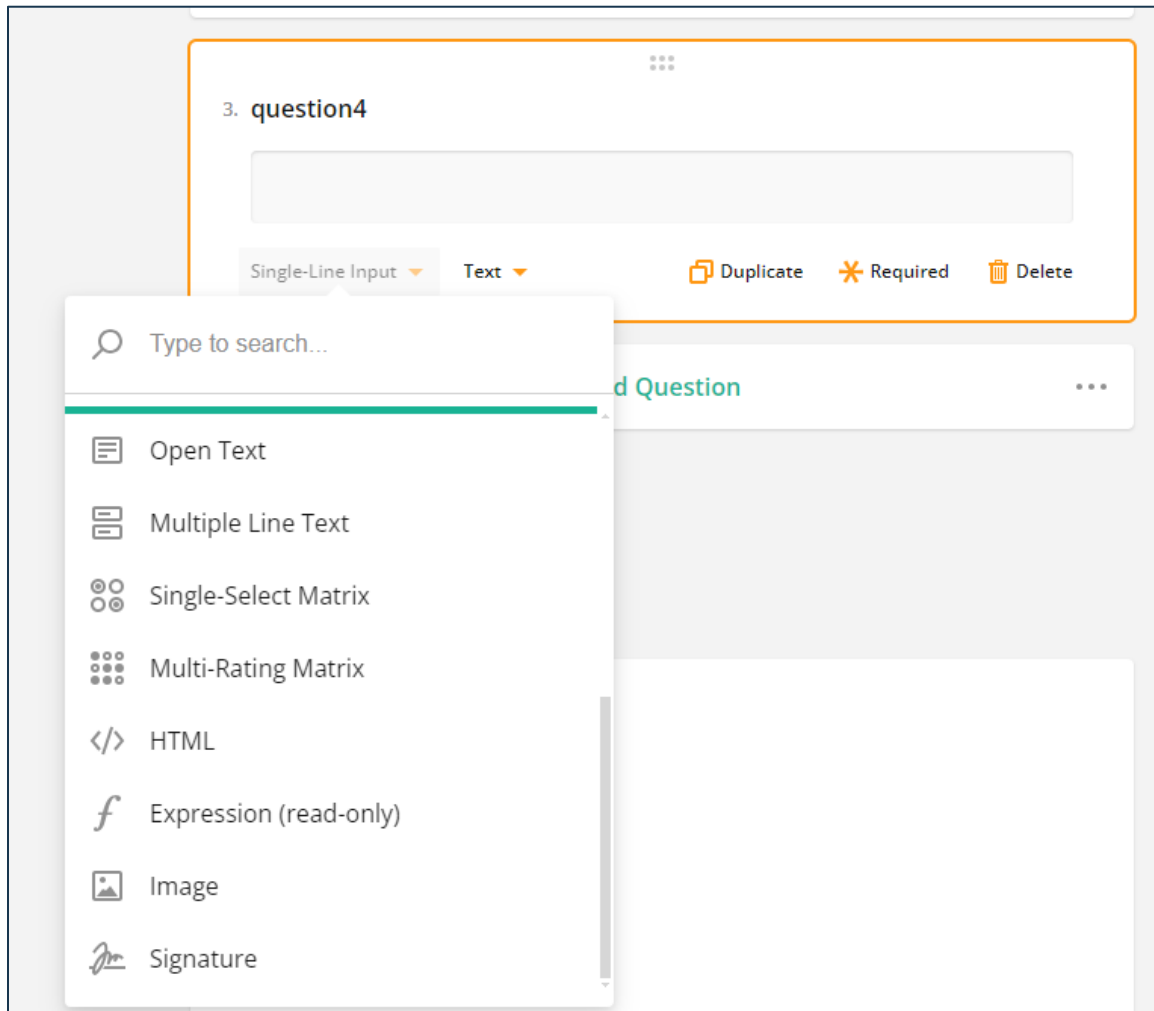

After either of these actions has been taken, a new question box will appear, the question-type will be visible in a dropdown in the lower left-hand corner of the question area.

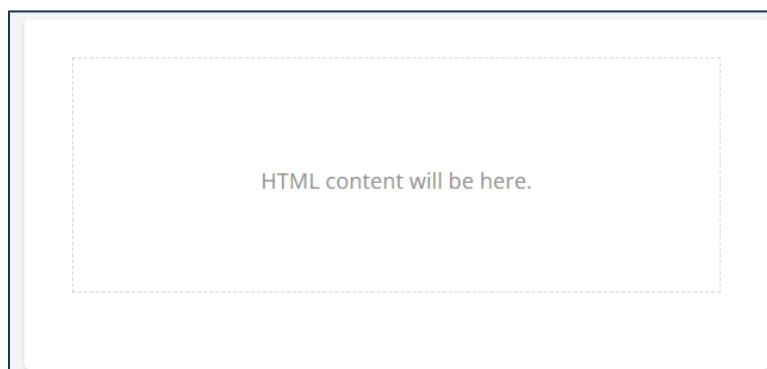

Step 4: Enter Markdown

Click anywhere within the area labeled “HTML content will be here.” This should highlight the question with an orange border and the section to the right will change to display the details of the selected question.

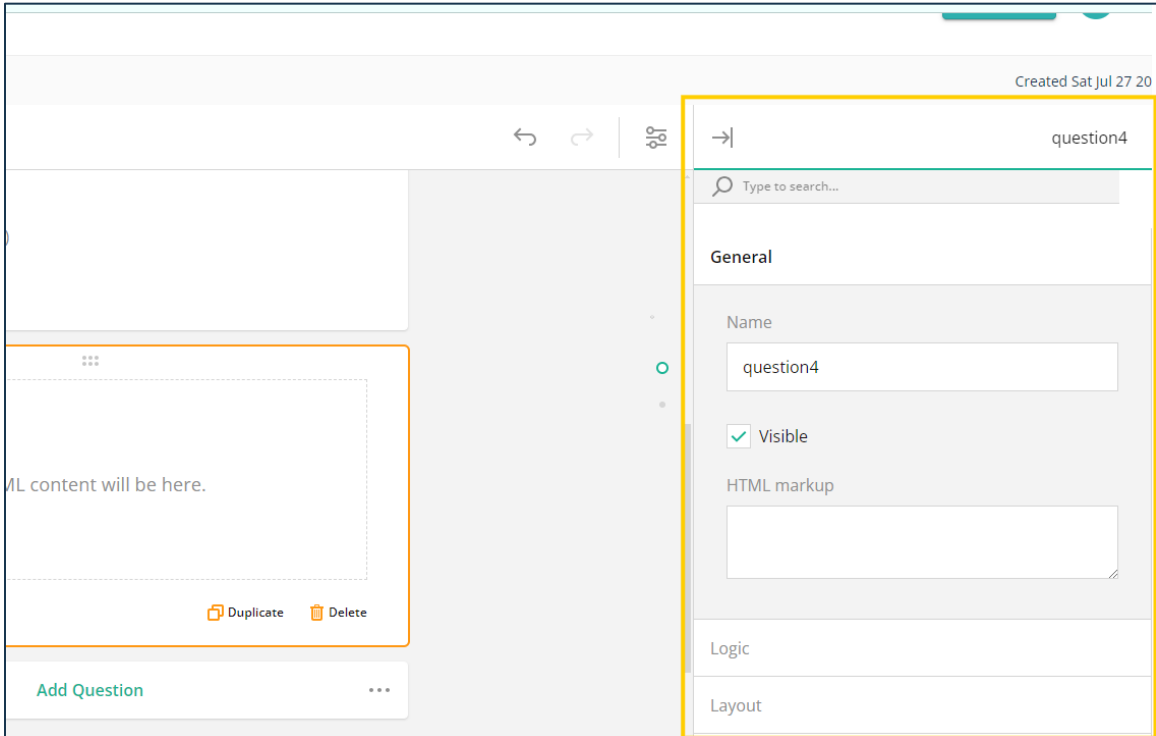

The screenshot displays the PsychData interface for editing a question. The main workspace shows a question card with a dashed border and the text "HTML content will be here." Below the card are "Duplicate" and "Delete" buttons. A right-hand sidebar is open, showing the details for "question4". The sidebar includes a search bar, a "General" section with a "Name" field containing "question4", a "Visible" checkbox which is checked, and an "HTML markup" text area. Below the sidebar are sections for "Logic" and "Layout". The top right corner of the interface shows "Created Sat Jul 27 20".

Click within the box below the label 'HTML markup' and enter your HTML markdown.

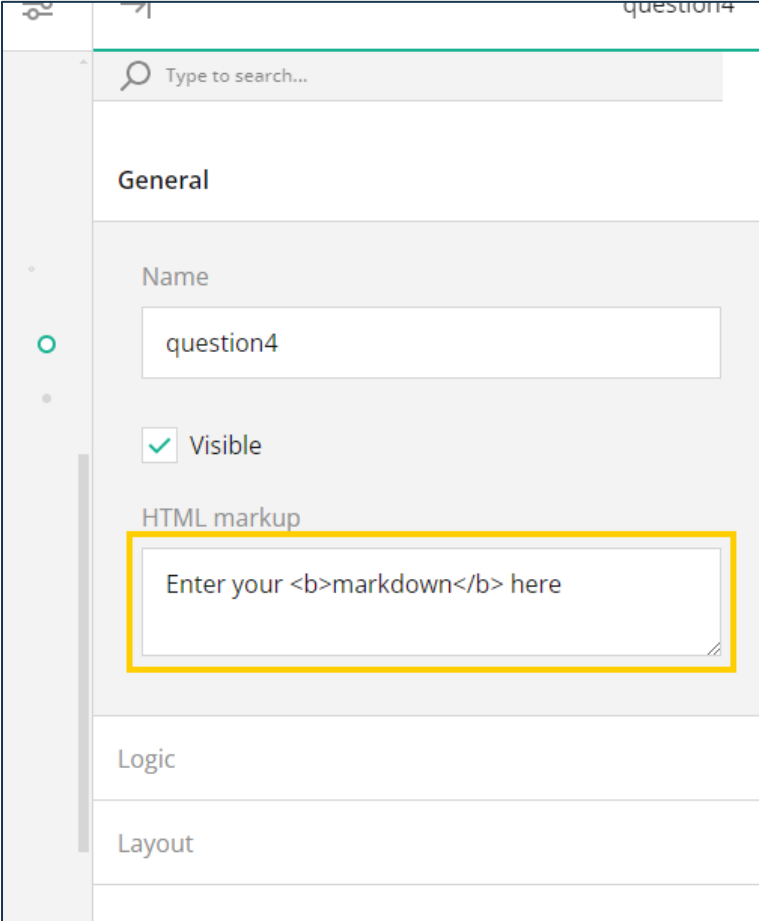

question4

Type to search...

General

Name

question4

Visible

HTML markup

Enter your `markdown` here

Logic

Layout

Add the HTML markdown in the box and it should display your coded text in the question area as seen below.

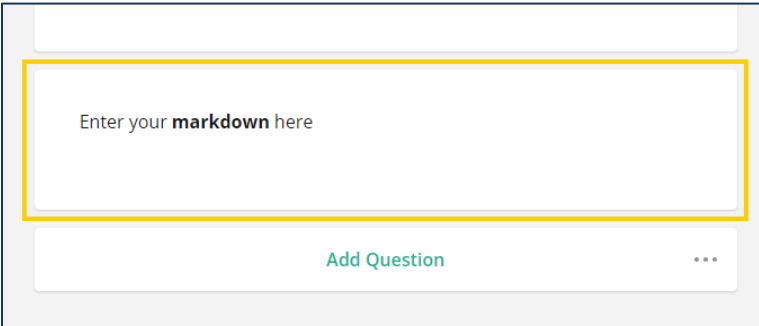

Enter your **markdown** here

Add Question ...